

Note: Part Number enclosed in brackets () are not available individually, but may be sold in assemblies or kits.

Ref	Description	Qty	900-E P/N	900-S/H P/N
1	CASE ASSEMBLY - SEE CATALOG XXX			
SNAP RINGS				
2	SNAP COVER (ALL MODELS)	1	21192101	21192101
2	RUBBER COVER KIT	1	212551	212551
INTERNAL ASSEMBLY				
4	INTERNAL ASSY (A)(B)	1	214700xx	214700xx
Cover Assembly				
5	SELF TAPPING SCREW	2	210974	210974
6	HOUSING COVER	1	210252	210252
7	COVER SCREW O-RING	2	211236	211236
NOZZLES				
8	NOZZLE HOUSING – BLACK (B)(D)	1	213710	213710
9	RANGE NOZZLE ASSY	1	213700xx	213700xx
10	SPREADER NOZZLE ASSY	1	-	-
11	RETRACT SEAL	1	210354	210354
17	STATOR/SCREEN KIT	1	21040301	21040301
	-STATOR	-	-	-
	-POPPET	-	-	-
	-SCREEN	-	-	-
BEARING/RISER-MOTOR ASSEMBLY				
12	NOZZLE HOUSING O-RING	1	210366	210366
13	BEARING GUIDE ASSY, STD	1	211147	-
13	BEARING GUIDE ASSY, LO-FLOW (E)	1	-	-
14	BEARING GUIDE O-RING	1	211242	211242
15	RISER MOTOR ASSY	1	21470000	21470000
	NOZZLE REPLACEMENT KIT W/ SEALS	1		
16	POP-UP SEAL (WHITE)	1	210399	210399

- A) SPECIFY NOZZLE SIZE WHEN ORDERING. AVAILABLE IN HIGH PERFORMANCE NOZZLE SIZES #44,48,52,56,60,64.
- B) FOR NON-POTABLE APPLICATIONS, USE STANDARD PART AND PURPLE SNAP RING P/N #21193404.
- C) THE NOZZLE HOUSING WAS CHANGED 8/99 TO ACCOMMODATE THE NEW SPREADER FOR HIGH PERFORMANCE NOZZLES. ALL 900 ROTORS AND NOZZLE/HOUSINGS MANUFACTURED AFTER 8/99 HAVE NEW NOZZLE HOUSING. UPGRADE TO HIGH PERFORMANCE NOZZLE.
- D) THE LO-FLOW BEARING GUIDE P/N # 211461 MAY ALSO BE USED ON THE 900 SERIES ELECTRIC ROTOR.
- E) FOR SMOOTH CASE ROTORS USE P/N #211598

Ref	Description	Qty	P/N
KITS & ACCESSORIES			
-	SNAP-COVER, YELLOW	1	21192102
-	SNAP-COVER, WHITE	1	21192103
-	SNAP-COVER, PURPLE (NON-POTABLE)	1	21192104
RUBBER COVER KIT (E/H/S)			(F)212551
-	RUBBER COVER, SNAP RING	1	-
-	SNAP RING, UPPER RUBBER COVER, HOUSING	1	-
-	RUBBER CASE CASE(E/H/S)	1	-
RUBBER COVER KIT (B & BRC)			211355
-	RUBBER COVER, SNAP RING	1	-
-	SNAP RING, UPPER RUBBER COVER, HOUSING	1	-
-	RUBBER CASE RING (B CASE)	1	-
5	COVER, YARDAGE MARKER BLANK (BLACK)	1	21175201

STATOR & POPPET CONFIGURATIONS – HIGH PERFORMANCE & STANDARD NOZZLES

COLOR	NUMBER	ELECTRIC PRESSURE SETTING				HYD
		PSI (BAR)				
		60 (4,1)	70 (4,8)	80 (5,5)	100 (6,9)	SAM B
BLUE	#44	SPC	SPC	SPC	SPC	SPC
YELLOW	#48	SPC	SPC	SPC	SPO	SPC
ORANGE	#52	SPC	SPO	SPO	SPO	SPO
GREEN	#56	NIR	SNP	SNP	SNP	SNP
BLACK	#60	NIR	SNP	SPR	SPR	SPR
RED	#64	NIR	NIR	SPR	SPR	SPR
WHITE	#18C	SPC	SPC	SPC	SPC	SPC
GRAY	#20C	SPC	SPC	SPC	SPC	SPC
BLUE	#22C	SPC	SPC	SPC	SPC	SPC
YELLOW	#24C	SPC	SPC	SPO	SPO	SPO
ORANGE	#26	SPO	SPO	SPO	SPO	SPO
GREEN	#28	NIR	SNP	SPR	SPR	SPR
BLACK	#30	NIR	SNP	SPR	SPR	SPR
BROWN	#32	NIR	NIR	SPR	SPR	SPR

SPC= STATOR W/ POPPET CLOSED SO= SCREEN ONLY
 SPO=STATOR W/ POPPET OPEN SPR=SPACER AND SCREEN
 SNP= STATOR NO POPPET NIR=NOT RECOMMENDED SETTING

SPREADER NOZZLES	
IF RANGE NOZZLE IS:	USE:
44-48	P/N # 213904 (BLUE)
52-64	P/N #213905 (BLACK)

STATOR WITH POPPET CLOSED SHOULD BE TIGHT WHEN SNAPPED IN

STATOR WITH POPPET OPEN SHOULD BE LOOSE WHEN SNAPPED IN

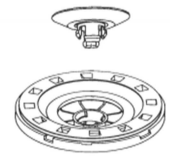
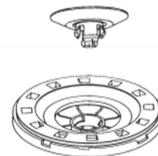

Note: Part Number enclosed in brackets () are not available individually, but may be sold in assemblies or kits.