



Elevating
Landscapes:
Irrigation Products
That Lead the Way

RAIN  **BIRD**®

Remote Irrigation Management Systems

Next-Generation Control Starts Here

Whether you're in charge of one controller or hundreds of controllers, Rain Bird® helps you boost efficiency, minimize site visits, and rest easy with 24/7 remote irrigation management through the Rain Bird 2.0 App, IQ™, or both.



Rain Bird 2.0 App

The Rain Bird 2.0 App streamlines installation, maintenance, and management of WiFi-enabled irrigation controllers. It boosts efficiency with quick search, mapping, and customization tools, supports easy sharing and team collaboration, and improves water management—helping users save up to 50% more water while maintaining healthy landscapes.







Rain Bird IQ

Rain Bird IQ offers powerful, cloud-based irrigation management from any device. It streamlines multi-site control, boosts efficiency with batch edits and reports, supports team collaboration, and saves up to 50% more water with smart, weather-based adjustments.



Rain Bird 2.0 App + IQ

Need the best of both worlds? Get the flexibility of using Rain Bird 2.0 App integrated with the power of IQ. Make quick adjustments to schedules and programs from the app in real-time. Then, utilize more advanced water management tools such as ET from a desktop on the IQ platform.

Station Capacity	
Flow Sensing	
Built-in Connectivity (No Upgrade Required)	App 2.0
	IQ
 	App 1.0
	App 2.0
 	IQ™
	IQ™ Only



SCAN TO DOWNLOAD
THE RAIN BIRD 2.0 APP TODAY



Comprehensive Control at Your Fingertips

Select the level of control your business needs, then remotely manage all sites from anywhere in the world with 24/7/365 access. Make on-the-spot changes to schedules and programs from the convenience of the mobile Rain Bird apps or via desktop on the Rain Bird® IQ™ platform.



RC2 ESP-TM2 ESP-ME3 ESP-2WIRE ESP-LXME2 ESP-LX-IVM ESP-BAT-BT
 ESP-LXME2 PRO ESP-LX-IVM PRO

Residential		Residential/Commercial		Commercial		Battery Operated
Fixed 8	Fixed 4, 6, 8, or 12	Modular 22	Fixed 50	Modular 48	Fixed 60 or 240	Fixed 1, 2, 4 or 6
-	-	✓	✓	✓	✓	-
WiFi	-	-	-	-	-	Bluetooth
WiFi	-	-	-	-	-	-
-	✓	✓	✓	✓*	✓*	-
-	✓	✓	✓	Coming in 2026		-
-	✓	✓	✓			-
-	-	-	-	✓	✓	-

*iOS Only

Connection Devices



LNK2 WIFI MODULE

Remote Access: Rain Bird 1.0 and 2.0 App
 LNK2 unlocks remote management potential by making on-site changes a breeze.



NCC 4G CELLULAR CARTRIDGE

Remote Access: Rain Bird IQ
 Bring IQ capabilities to any LX Series controller via cellular connection.

NEW



Remote Control Device:

The Rain Bird to Rain Master ProMax Remote Adapter lets you use your existing Rain Master ProMax remote (Model: PROMAX) across the Rain Bird controller family. Expand your control, improve compatibility, and simplify on-site management—all with one easy connection.

LNK™ 2 WiFi Module

LNK2 upgrades the ESP-2WIRE, ESP-ME3, ESP-Me, ESP-TM2, ESP-RZXe, ESP-LXME2 and ESP-LXIVM controllers with WiFi capabilities, allowing for system management from any place, at any time, with the mobile app.

Just plug in the module to your controller, pair it with the free Rain Bird® Mobile App and get real-time alerts.



LEARN MORE



Model:
LNK2WIFI



Now with a strengthened network connection and Bluetooth® Fast Pair

Easily upgrade from App 1.0 to Rain Bird 2.0 to access new irrigation features.

LNK2 compatibility available for Apple® iOS. Android™ compatibility is coming soon.



Experience the difference with instant connectivity

- Unlocks WiFi capabilities in our most popular controllers, making them fully accessible and programmable from iOS or Android compatible devices
- Smart Home Compatible (North America, Europe, and Australia)



Achieve peace of mind

- Receive push notifications for irrigation and weather-based events
- Tailor alerts so you only get the information that matters
- Enable remote diagnostics, set up service calls, access troubleshooting, receive freezing conditions warnings, and much more
- Save up to 50% in water with automatic weather-based adjustments to run times

Access our free professional app and manage multiple sites

- Use your phone like a wireless remote or operate the controller at the controller—you choose
- Water a single zone, all zones, or set a custom schedule
- Simple, multi-site management



Rain Bird® IQ™

Take control of your irrigation business and your reputation with remote access to irrigation systems from any web-enabled device.

Rain Bird IQ offers state-of-the-art monitoring, programming and control features in one easy-to-learn user interface so you can spot an issue from a mile away...or a thousand miles away. Stay ahead of the curve with built-in evapotranspiration (ET) intelligence, automatic weather-based adjustments, catastrophe avoidance and more.



LEARN MORE



Starring streamlined navigation

- Quick and simple setup
- User-friendly, intuitive interface
- Time-saving batch editing capabilities across multiple controllers and sites

Tools for every need

- Tiered user access levels with varied permissions
- Analyze and edit programming without interrupting irrigation
- Ad-hoc and automatic reports for easier data analysis
- Gain remote access to LX Series controllers with IQ cartridges

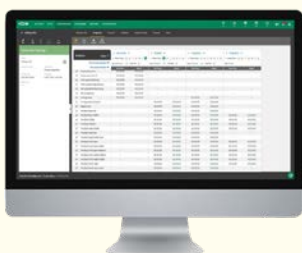

Equipped with a modern user interface

- Accessible from any device connected to the internet
- Fully optimized for smartphones and tablets
- Brings automatic daily seasonal adjust to all LX Series controllers
- All features available on any device

RC2 controllers now available in IQ

- ✓ Controller Sharing—the easiest and most secure way to share access available
- ✓ Site Transfer—grants ownership access and changes
- ✓ Standard ET—new and improved version of Simple ET
- ✓ Cycle + Soak™ suggestions
- ✓ New options for individual user preference management
- ✓ Improved capabilities in Snapshot + Restore Data
- ✓ Many more ease-of-use improvements making IQ better than ever!



Ideal for irrigation professionals managing multiple controllers and / or sites. Collaborate with multiple users and between accounts with ease.

RC2 WiFi Controller

Increase Productivity with Smart Control

- Lightning-fast in-field setup
- No WiFi available? Try Guest Mode
- IQ integrated with remote management
- Unlimited Shared Access
- Copy and paste saved programs in a snap with scheduled templates
- Forecasted weather delays prevent irrigation when rain is forecasted

SMART HOME INTEGRATION



Connects to
Rain Bird 2.0 App and IQ



Model:

RC2-120V: 8-Station

Accessories:

WR2-RFC: Rain + Freeze Combo

WR2-48: Rain + Freeze Combo with 48-hour hold

RSD-BEx: Rain sensor with latching bracket, extension wire



LEARN MORE

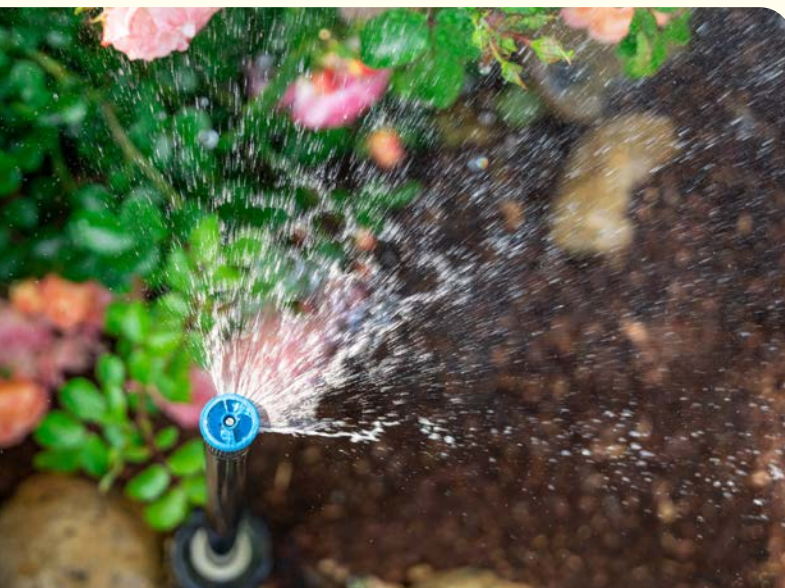

Quick to Install and Simple to Program

- Quick Pair Technology for fast and seamless mobile connection
- Three available programs with up to four start times for each program
- Schedule templates allow contractors to save commonly used programs to import to a controller quickly and easily

Advanced features

- Delay Watering up to 14 days and automatically resume after the set delay has elapsed
- Cycle+Soak™ by station give the contractor and homeowner an easy way to prevent wasted water due to run-off
- Seasonal Adjust by program allows you to reduce or increase watering by program
- Forecasted weather delays prevent irrigation when there is rain, wind, or freezing temperature in the forecast

Coverage with or without WiFi

- User-friendly mobile app interface gives contractors and homeowners access from anywhere in the world
- Guest Access mode will allow connection to the controller with the push of a button for easy on-site contractor access

2-Wire Controller with Decoder Auto-Address



ESP-2WIRE Controller

Experience 2-Wire benefits without the hassle.

The ESP-2WIRE Controller and 2W-1 Decoder continue Rain Bird's legacy of the best-in-class 2-Wire experience with an approachable platform for projects up to 50 stations. With the addition of Decoder Auto-Address, contractors can now take advantage of all 2-Wire benefits with a familiar platform that's easy to install and program.



Add Remote Connectivity with the LNK™2 WiFi Module



Remote Irrigation Management

Connects to Rain Bird 2.0 App and IQ

50-station capacity

- Accommodates up to 50 stations plus master valve
- No need for expansion modules

Low system cost and easy installation

- Standard direct burial wire
- Standard wire connectors
- No field grounding requirements

Significant time savings

- Automatically detects decoder addresses connected to the 2-Wire path
- Automatically assigns decoder addresses to station numbers

Control through the Rain Bird Mobile App

- Connects to WiFi for access anywhere in the world
- Local access through the mobile app with LNK2 when WiFi is not available on site
- Program addresses, rearrange, view status, and troubleshoot decoders all from your mobile device

At-a-glance troubleshooting

- Status LED on controller back panel for real-time insight
- LED status indication lights for each individual decoder

Model:

ESP-2WIRE: 120VAC

Accessory:

2W-1 Decoder: Compatible decoder for ESP-2WIRE Controller



ESP-LXME2 Next Generation Traditionally-Wired Controller

Where tradition meets innovation.

The popular LXME Series commercial controllers have been upgraded, now offering up to 40 programs, a simplified user interface, additional connectivity options, and more. The LXME2 Controller provides flow sensing and management with modular station capacity from 12 to 48 stations.



PRO

Ask about the LXME2 PRO.

Attach a flow sensor input and a second booster pump circuit or normally closed master valve. (Available factory or field installed.)



COMING IN 2026

LNK™2 WiFi Module on the Rain Bird 2.0 App for the LXME2 and LXIVM controllers.

IOS and Android with flow management and notifications.



Modular design

- Perfect for traditionally wired new installs or retrofit applications
- Easy upgrade from LXME to LXME2 by swapping the front panel*
- 12-station base unit expandable to 48 stations with 12-station modules*

MODULAR UPGRADES

- ▷ **PRO:** Flow sensing and additional second Booster Pump Circuit programmable by station
- ▷ Station capacity
- ▷ Metal case and pedestal
- ▷ NCC Network Communication Cartridges

Intuitive operation

- Large backlit LCD display with easy-to-navigate user interface
- Six user-selectable languages
- Add or remove modules without powering down
- Copy/paste runtimes and Cycle+Soak™ programming from one station to many

Powerful water management

- FloWatch™ protection for high and low flow conditions
- FloManager™ manages hydraulic demand
- SimulStations™ allow up to five stations to operate at once
- Water Windows by program plus Manual MV Water Window
- Cycle+Soak™ by station
- Intelligent calendar and weather-based delays

*Only 12-station modules are compatible with the LXME2



WatchDog® ET Weather Station

Maintain optimum turf quality with real-time evapotranspiration (ET) data that reflects your most critical site conditions.

- Quick start installation
- Integrated solar power system

Seamlessly integrate with Rain Bird® IQ™

- Easily connects to view ET, rainfall, temperature, humidity, wind speed/direction, and solar data
- Automate irrigation schedules with real-time conditions
- Access from desktop, tablet, or mobile from anywhere
- Generate detailed irrigation and weather reports
- Monitor live and historical data

Models:

WatchDog 3550 Wireless ET Station
Cellular (LTE-CAT4 Modem - US/Canada)

WatchDog 3550 Wireless ET Station
Cellular (LTE-CAT4 Modem - Global)

Accessories:

Tripod with Ground Stakes



Models:

ESP-HT2 - GHT: Brass female GHT coupler and brass GHT male threaded outlet

ESP-HT2 - BSP: Brass female BSP coupler and brass BSP male threaded outlet

ESP-HT2 Premium Hose End Timer

Reliable and flexible hose end timer for residential applications.

Automate your hose-end sprinklers, drip Irrigation system or soaker hose with this premium Hose End Timer. Available in Garden Hose Thread (GHT) and British Standard Pipe (BSP) configurations, these timers feature sophisticated automatic programming flexibility along with an extra rugged design for worry-free outdoor watering all season.



ESP-BAT-BT

The Modern TBOS—Tougher, Smarter, and Built for What's Next

It's more than a controller—it's the launch pad for Rain Bird's next wave of wireless innovation. The ESP-BAT-BT delivers what TBOS never could: best-in-class battery life and management tools, smarter app control, deeper visibility, and automation features that cut down site visits and give crews more time back in the field.

Models:

ESPBAT-BT1: One Station Bluetooth Battery-Operated Controller

ESPBAT-BT2: Two Station Bluetooth Battery-Operated Controller

ESPBAT-BT4: Four Station Bluetooth Battery-Operated Controller

ESPBAT-BT6: Six Station Bluetooth Battery-Operated Controller

Model Details:

- All models come with a dedicated MV wire
- All models have sensor port and wire
- One and two station units have one common wire. Four and six station units have two common wires.
- IP68 rated, rigorously-tested waterproof design protects against the harshest conditions

Accessories:

- BAT-BT Potted Latching Solenoid
- BAT-BT Solenoid Adapters

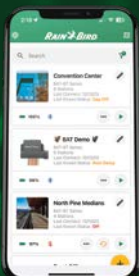

Built-in Bluetooth connectivity for total control with Rain Bird 2.0 App



LEARN MORE



Remote Irrigation Management

Connects to Rain Bird 2.0 App

Coming Soon: BAT-PRO

Same app, same work flows, broader horizons

Love the BAT-BT but wish you could go beyond Bluetooth range?

Built to go the distance—and designed to take you further.

Smarter control. Fewer trips. More efficiency.

- Up to 5 years of battery life on four AA batteries
- Predictive battery visibility based on real programming
- Effortless controller sharing, anytime with anyone
- View and edit schedules offline for faster on-site workflows
- Advanced mapping with clear battery status indicators
- Full-year Seasonal Adjust (plan months ahead, reduce return trips)
- Search, sort, and filter controllers across all sites

Rugged, Battery-Operated Controller

ESP-9V Battery-Operated Controller

Get reliable, automatic irrigation control, even when you don't have AC power—now with a 5-year warranty included.

Built to be installed virtually anywhere, the ESP-9V operates reliably for more than two years using two 9V batteries. With a waterproof case and dual-sealed battery compartment, life in a wet, dirty valve box is no problem. Get the convenience and efficiency of automatic irrigation control with the ESP-9V. Easy to use, easy to install, easy to own.



LEARN MORE



Reliable and long-lasting design

- Plastic, weatherproof controller case with outstanding resistance to weather, yellowing and aging
- Operates for approximately one full year using one 9-volt alkaline battery, or two years with two 9-volt alkaline batteries
- 5-year warranty included
- Sensor input with bypass override
- Master valve/pump-start circuit (multi-zone units only)
- Non-volatile (100-year) program memory
- IP68 certified for protection against dust and water intrusion

Straightforward and user-friendly

- Large LCD display with simple-to-navigate user interface
- Dedicated manual watering button for easy operation
- Automatic zone-stacking ensures that only one valve irrigates at the same time
- Contractor Rapid Programming™ feature
- Run times, start times, and watering days are customizable by zone
- Six start times per zone, four watering day options per zone
- Delay watering (one to nine days)



Models:

- ESP9V1:** 1-Zone ESP-9V Controller
- ESP9V2:** 2-Zone ESP-9V Controller
- ESP9V6:** 6-Zone ESP-9V Controller
- ESP9V1SOL:** 1-Zone + 9V Solenoid



FG100 Flow Sensor

Defend against leaks with flow-sensing technology.

Designed for residential and smaller commercial applications, the FG100 monitors irrigation and instantly identifies when there is a leak or line break so it can be addressed early. This durable flow sensor manages water efficiency, protects homeowners from potential damages, and positions you as a guardian of your customers' property and landscape—earning you a stronger reputation over time.



Models:

A83926 FG100: 1" (25.4 mm) Flow Sensor NPT

A83927 FG100: 1" (25.4 mm) Flow Sensor Slip



LEARN MORE



Provides maximum value

- A low-cost upfront investment
- Pays for itself with preventing just one leak
- Saves time, saves labor, and pinpoints issues faster
- Compatible with standard K-Factor and Offset controllers

Straightforward and convenient

- Quick and easy to install
- Added with 18g irrigation wire—no specialty PE-Cable
- Winterization-ready upon install
- No straight-pipe requirements



Pair the FG100 Flow Sensor with the ESP-ME3 Controller to check system health from anywhere via the Rain Bird Mobile App, available for iPhone® and Android™, when adding the LNK™2 module.

*SOURCE: Wireless and Wired Flow Sensors and Dedicated Submeters Used to Manage Large Residential Estates and Improve Irrigation Efficiency Report



Ultrasonic Flow Sensors

The most advanced irrigation flow sensor available.

The Ultrasonic Flow Sensor (UFS) by Rain Bird® is what modern irrigation has been waiting for. Accurately measure very low and high flow rates, all in one sensor. Advanced sensing technology produces stable and accurate readings with no straight-pipe requirements. Enjoy new flexibility in system design and place your Ultrasonic Flow Sensor anywhere on your irrigation system—even in the same valve box as your master valve.



LEARN MORE



Low and high flow measurement

- Wide flow range perfect for systems with multiple emission devices
- Ultrasonic transducer and reflector technology means more precision than traditional impeller meters
- **Flow Ranges:**
 - **UFS100:** 0.3–50 GPM
 - **UFS150:** 0.5–110 GPM
 - **UFS200:** 1.0–200 GPM

Long-term dependability

- No moving parts for greater lifespan
- On-board LED lights for immediate status feedback
- Special body material grants high pressure and working temperature ratings

No straight-pipe requirements

- Specialized design requires no straight pipe before or after the sensor
- Install near pipe bends or valves with consistent performance
- Save on time and material—install in the same box as your valve

Models:

- UFS200:** 2" (50 mm) Ultrasonic Flow Sensor
- UFS150:** 1 ½" (40 mm) Ultrasonic Flow Sensor
- UFS100:** 1" (25 mm) Ultrasonic Flow Sensor

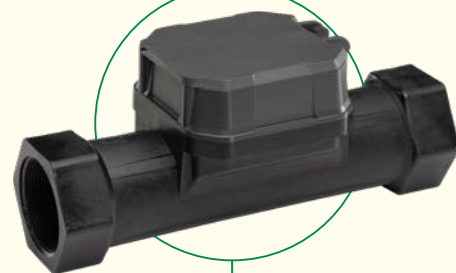

The Valve Line That Leads the Field

Proven. Tough. Smart.

The Right Valve, Every Time

From the purest water source to the harshest commercial environment, you'll get lasting confidence your system is performing.

More Competitive Than Ever!

- **100HV with DV solenoid:** most reliable production home valve
- **100DV:** positioned to stand against leading competitors
- **100DVF:** cost-effective light commercial valve that meets the same performance specs as other leading brands
- **100PGA:** sets the industry standard for commercial irrigation valves
- **100PE:** most rugged and durable commercial valve



LVF Series

Designed for optimal performance at low flows



HV Series

Easy install for residential communities



DV/DVF Series

#1 Market choice known for consistent reliability



PGA Series

Affordable option for larger pipes and 2-wire technology



PEB/PESB Series

Durable for a wide variety of flows, even with dirty water



BPES Series

Designed to withstand extreme pressure and debris



EFB-CP Series

Brass valve with a long life for high-performance applications



LEARN MORE



11000 Series Rotors

Engineered for sports fields and large turf applications.

11000 Series Rotors feature a minimally exposed surface to protect athletes while providing superior distribution uniformity and enabling a greener and higher performing field of play. Easy installation and top-serviceable maintenance ensure cost savings at every turn.

Superior performance, smaller footprint

- 105' (32.0 m) of true coverage/throw
- Irrigate a field 25% larger with 40% fewer rotors than traditional rotor solutions
- Fewer components and less piping required
- Reduces installation time and cost

Inspired by sports turf professionals

- Optional opposing nozzle available
- Increased droplet size for maximum efficiency and uniform coverage
- Nozzle pre-installed for quick installation
- Industry-best popup height means less mowing

Hassle-free maintenance

- Intelligent snap ring design
- Top-serviceability
- Quick access to serviceable components
- Arc adjustments performed using a standard rotor tool

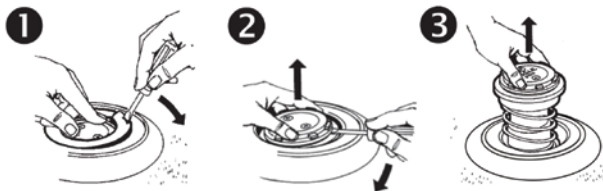

Models:

11004: 1.5" ACME female-threaded inlet

11004-ON: 1.5" ACME female-threaded inlet with opposing nozzle

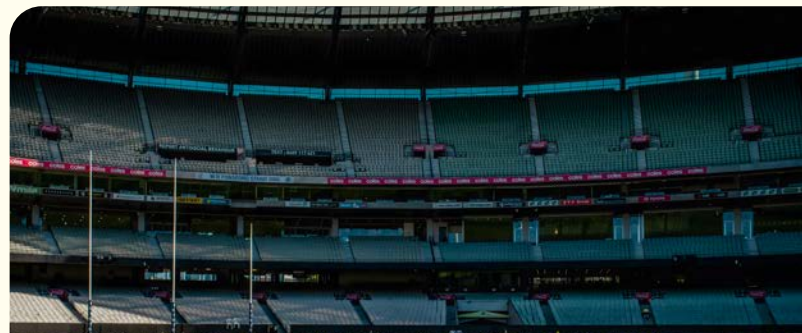

All-in-One Zone Control

Rain Bird redefines drip zones

The new All-in-One Zone Control (XAOZ100) combines a 40-PSI regulator, 150-mesh filter, and long-life valve into a single compact device with the widest operating range available—making it your new go-to for any commercial drip zone.

Specifications:

Operating Pressure: 15 to 150 PSI

Regulated Outlet Pressure: 40 PSI

Minimum Required Inlet Pressure (for 40 PSI at outlet): 50 PSI

Operating Flow: 3 to 30 GPM

Dimensions: 9.5" inlet to outlet, 7.75" tall, 4.25" wide



The only commercial drip valve you need

- Widest operating range and smallest footprint available
- Purple handle included for non-potable systems

Ready to install

- Compact single device that installs quickly and easily
- Includes pre-installed manual ball valve for maintenance

Under pressured?

- Works with lower supply pressures than control-zone kits

Clients should admire their landscapes, not our valve boxes

- Up to 6 inches shorter than control-zone kits
- Fits in a mini standard valve box
- Two units fit in one standard valve box

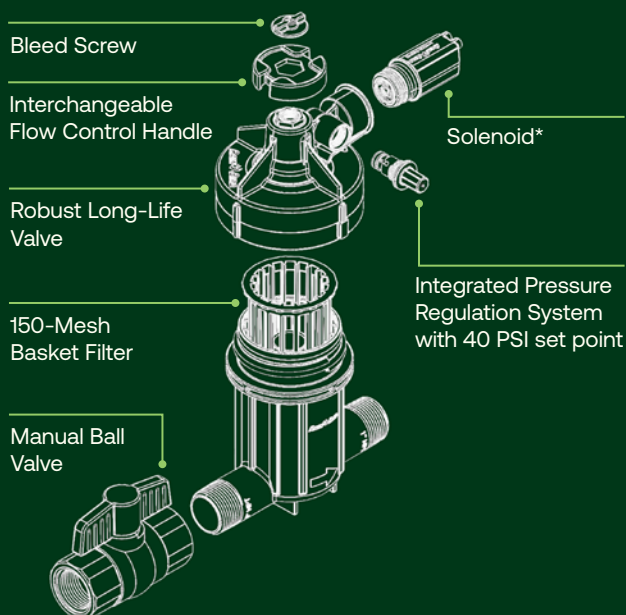

*Compatible with traditional-wired, 2-wire, and IVM controls.



Root Booster Series

Deliver water exactly where plants need it—their roots.

Root Booster Series products provide an efficient underground system for water distribution, supplying air and water right to the roots. Highly compatible with natural and automated irrigation, the Root Booster Series is lightweight, simple to install, and effective even in the harshest environments. With three convenient formats, Rain Bird's Root Booster products are all "set it-and-forget-it" solutions for environments where you need consistent growth.

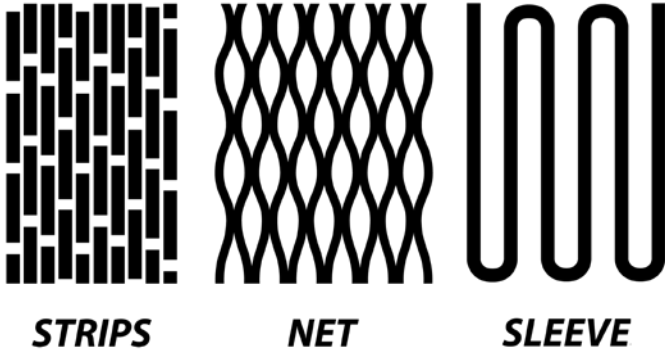

STRIPS

NET

SLEEVE



INTERNAL STRUCTURE RETAINS
85% OF ITS SIZE IN
WATER

LEARN MORE



Applications:

- ✓ Roof Gardens
- ✓ Athletic Fields and Lawns
- ✓ Beds and Containers
- ✓ Trees
- ✓ Slopes
- ✓ Heat Islands



Available in
Biodegradable or
Permanent variations.



Root Booster STRIPS

STRIPS are specifically crafted to be mixed into the soil near the roots to enhance irrigation and substrate permeability. STRIPS resist compaction and promote aeration, providing the optimal supply of water and air for your plants.

LEARN MORE



Root Booster NET

When installed root-deep in the soil or around the root ball of a tree, NET absorbs water and conducts it to the roots. A complement to your irrigation, the open net design provides ample space for roots to establish and grow. NET delivers water and air across large areas and can be cut to fit any project.

LEARN MORE

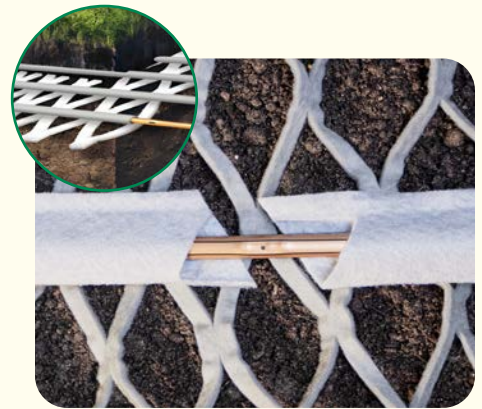

Root Booster SLEEVE

Root Booster SLEEVE is the subsurface dripline covering that not only nourishes your plants, but also shields your dripline from animals, shovels, soil compaction and more. Ideal for quickly draining soils and slopes, SLEEVE minimizes water-loss and holds water from the dripline directly at the roots.

LEARN MORE



UltraXP Poly Tubing

Strong, flexible drip irrigation tubing that lasts.

Introducing the strong and flexible drip irrigation tubing engineered to withstand the most challenging installations. Specifically designed for point-source drip irrigation systems, UltraXP combines a thicker tube wall and resins chosen to deliver long-lasting protection from the toughest job site conditions.

LEARN MORE



Available Models:

UltraXP - 700 Series (1/2")

UXP700250: No Stripe, 250 ft. (76 m) coil

UXP700500: No Stripe, 500 ft. (152 m) coil

UXP700G250: Green Stripe, 250 ft. (76 m) coil

UXP700G500: Green Stripe, 500 ft. (152 m) coil

UltraXP - 710 Series (1/2")

UXP710250: No Stripe, 250 ft. (76 m) coil

UXP710500: No Stripe, 500 ft. (152 m) coil

UXP710G250: Green Stripe, 250 ft. (76 m) coil

UXP710G500: Green Stripe, 500 ft. (152 m) coil

UXP710P250: Purple Stripe, 250 ft. (76 m) coil

UXP710P500: Purple Stripe, 500 ft. (152 m) coil

UltraXP - 940 Series (3/4")

UXP940G500: Green Stripe, 500 ft. (152 m) coil

UXP940P500: Purple Stripe, 500 ft. (152 m) coil



ULTRA Strong

Specifically formulated resin blend bolstered by extra UV stabilizers, UltraXP features an inner wall that is 22% thicker than most poly tubing. Don't take our word for it, pinch the tube to see for yourself.

ULTRA Easy to Install

Utilizing a unique blend of resins, UltraXP delivers both toughness with its thick wall and the flexibility you need for easy and quick installations.

ULTRA Long-Lasting

UltraXP boasts a thick inner wall encased in an all-virgin outer layer fortified with UV protection. This construction renders it highly resistant to abrasion, foot traffic, and damaging effects of the elements. Plus, rest assured with our 7-year warranty against environmental stress cracking.

Color Options

UltraXP brings organization beneath the surface with high-visibility color striping variations, allowing for easier differentiation of zones within the same trench.

UltraXP is available in:

■ No Stripe – 250' and 500' coils

■ Purple Stripe – 250' and 500' coils

■ Green Stripe – 250' and 500' coils

XFDe Dripline

Longer lateral run lengths and higher kink resistance.

Utilizing a revolutionary new emitter technology developed by Rain Bird engineers, XFDe dripline is ideal for large zones where dripline laterals may exceed up to 600 feet or more. The new low-profile pressure-compensating emitter reduces friction loss within the tube, enabling extra-long maximum lateral run lengths. XFDe dripline laterals can be installed up to 50% longer than competitor products. XFDe dripline is even more flexible and kink resistant, allowing for an easy and quick installation even on the coldest days.



LEARN MORE



Reliable

- Consistent flow over the entire lateral length
- Higher uniformity at inlet pressures up to 60 PSI

Cost effective

- Longer dripline laterals allow for larger zones and lower material and installation costs
- Dual-layered tubing for unmatched longevity

Easy to install

- Greater flexibility and kink-resistance
- 3" bend radius in any direction, even in the cold
- **Accepts the following fittings:**
 - RainBird XF Insert
 - Easy Fit Compression
 - 17 mm insert
 - LOC

Available Options:

- 0.6 and 0.9 GPH
- 12" and 18" spacing
- 250' and 500' coils
- Non-potable purple and purple stripe



SQ Series Nozzle with $\frac{3}{4}$ Square Pattern

Precise and efficient, low-volume spray nozzle for irrigation around the perimeter of trees or shrubs.

SQ Series Nozzle with $\frac{3}{4}$ Square Pattern is pressure compensated, ensuring a precise and efficient, low volume spray for surface watering the perimeter of trees and shrubs, while avoiding the trunk. With the unique edge-to-edge pattern, coverage is achieved with only two nozzles, making them a cost effective solution.



LEARN MORE



Models:

SQ-3QTR: SQ Nozzle, three-quarter pattern

SQ-QTR: SQ Nozzle, quarter pattern

SQ-HLF: SQ Nozzle, half pattern

SQ-FUL: SQ Nozzle, full pattern

SQ-ADP12: SQ Nozzle Adapter with 12" PolyFlex Riser

SQ-ADP: SQ PolyFlex Riser Adapter only



Unique pattern for trees

- Designed to irrigate precisely around the perimeter of trees and shrubs
- Great for corners in narrow planting beds, parking lot islands, walkways, parkways, and street medians

Impressive versatility

- Application flexibility simplifies design and installation
- Can be installed on a variety of spray heads and risers
- One nozzle throws 2.5' or 4' (0.8 m or 1.2 m)

Unbeatable savings

- Fewer nozzles needed due to unique square pattern with edge-to-edge capability
- Decreases cost and installation time
- Reduces overspray, property damage, and liability
- Meets micro irrigation system requirement with less than 26 GPH flow rate at 30 PSI



Rain Bird® to Rain Master® ProMax™ Remote Adapter

Remote Control Options for Rain Bird® Controllers Now Available

The Rain Bird to Rain Master ProMax Remote Adapter lets you use your existing Rain Master ProMax remote (Model: PROMAX) across the Rain Bird controller family. Expand your control, improve compatibility, and simplify on-site management—all with one easy connection.

LEARN MORE



*ProMax Remote
sold separately.*

Seamless Compatibility

Works with most Rain Bird commercial and residential controllers

Easy Setup

Plug-and-play interface allows fast installation and intuitive use

Durable and Flexible

Optional permanent cables help prevent wear or pin damage from repeated use



Service Parts

G5 Solenoid

- Fits all commercial valves and DV series valves
- Interchangeable with the G4 and DV solenoids
- Universal solenoid a great solution for reducing the number of SKUs necessary for stocking

ESP-ME3 Zero Base Module

- Master valve, common, stations 1-4 comes pre-installed on new units
- Replacements are easier
- Reduces controller returns



Rapid Ship CLP Pump Stations

Now with shorter lead times.

Featuring an industrial-grade pump, marine-grade aluminum enclosure, and optional mounting for a Rain Bird controller. Includes UL-listed components and a three-year warranty for top-tier pump protection. Perfect for flows up to 160 GPM.



LEARN MORE



Model Comparison:

3 HP Models

CLP03AAC4RS: CLP, 3HP PUMP A, BST, AL, CARBON STEEL PIPE, 208-230VAC, 1P

CLP03CAC4RS: CLP, 3HP PUMP C, BST, AL, CARBON STEEL PIPE, 208-230VAC, 1P

5 HP Models

CLP05EAC4RS: CLP, 5HP PUMP E, BST, AL, CARBON STEEL PIPE, 208-230VAC, 1P

CLP05FAC4RS: CLP, 5HP PUMP F, BST, AL, CARBON STEEL PIPE, 208-230VAC, 1P

7.5 HP Models

CLP07HAC4RS: CLP, 7.5HP PUMP H, BST, AL, CARBON STEEL PIPE, 208-230VAC, 1P

CLP07JAC4RS: CLP, 7.5HP PUMP J, BST, AL, CARBON STEEL PIPE, 208-230VAC, 1P

10 HP Models

CLP10LAC4RS: CLP, 10HP PUMP L, BST, AL, CARBON STEEL PIPE, 208-230VAC, 1P

At-a-Glance

- Ideal for pressure boost, flooded suction, or suction-lift applications
- Variable Frequency Drive (VFD)
- Pump Start Relay included (24VAC/DC)
- Marine-Grade Aluminum Deck and Enclosure
- Powder-coated steel piping
- Isolation Valves for easy maintenance
- Flanged inlet and outlet connections
- Manual Switch for full user control and override capabilities
- Mounting options for Rain Bird Controllers (purchased separately)
- Available in single phase 208V, 220V, and 230V
- Flow Start Kit
- Surge Suppression Kit

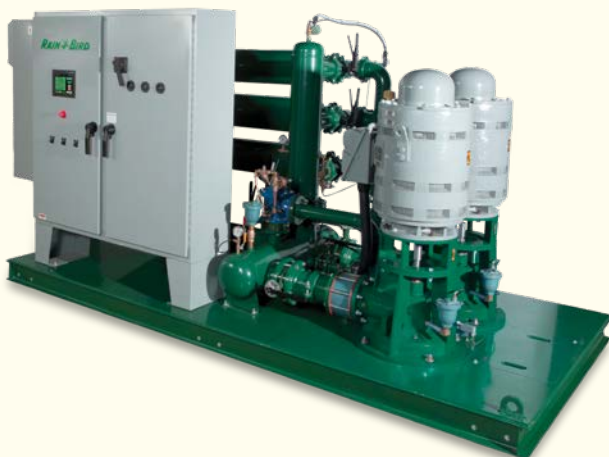

Rain Bird Learning

Ready, Set, Grow!
Learn Anytime, Anywhere.

Rain Bird Learning offers comprehensive, best-in-class product and irrigation training. With hands-on, in person, and on-demand options, our programs help you refine skills, avoid rework at the jobsite, and increase efficiency through training tailored to all levels and job roles.

Give your business an edge over the competition with our world-class training that provides everything you need to *crush it* as an irrigation professional.

Enroll today to put you and your company miles ahead of your competition.

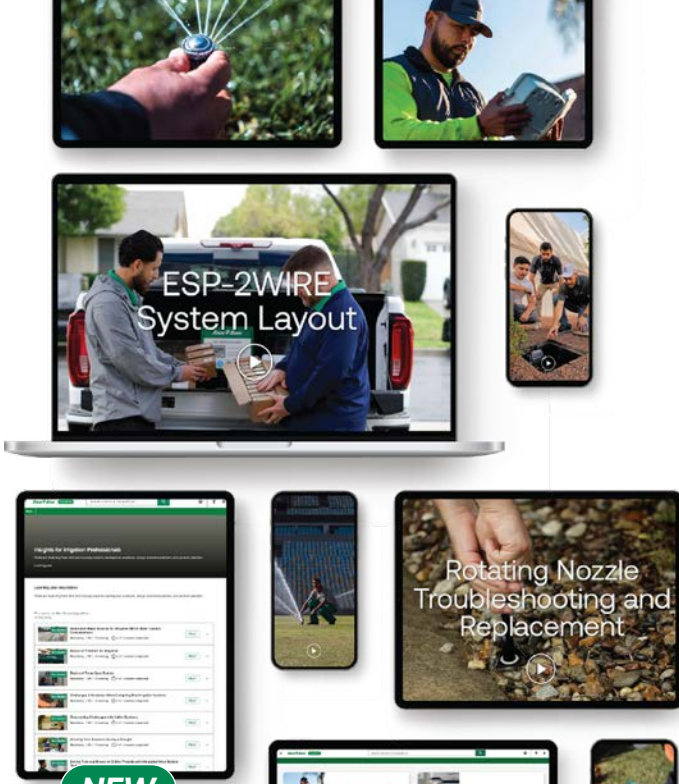

NEW

The New Era of Continuous Growth

With over 90 years of industry experience, Rain Bird knows irrigation—and it's time to pass that knowledge on to you.



IN PERSON AND ONLINE

- Rain Bird On Demand
 - Irrigation Learning
 - Product Learning
- Rain Bird Academy
 - Factory Trained
 - Industry Trained
 - Professional Webinars

Rain Bird On Demand

Access free, on-demand irrigation training wherever and whenever it fits your schedule. Rain Bird On-Demand courses make it easy to expand your skills, from product know-how to irrigation fundamentals, all at your own pace.

Irrigation Learning

Free, self-paced training on best practices.

Product Learning

Free, self-paced Rain Bird product training.

Webinars

Advance your knowledge of irrigation with professional webinars.

Rain Bird Academy

Instructor-led technical classes designed to expand your irrigation knowledge. Learn directly from certified trainers in small, interactive sessions focused on real-world applications. Affordable and accessible, Rain Bird Academy helps you gain practical skills you will use.

Industry Trained

Professional, non-manufacturer specific irrigation training.

Factory Trained

Comprehensive training on Rain Bird products and systems.

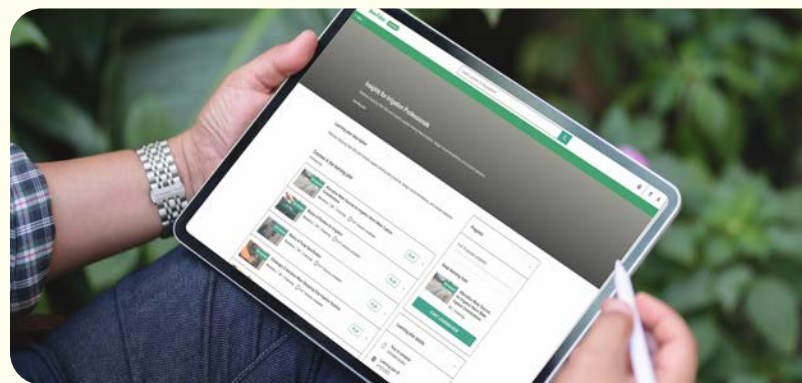

Your path to growing your expertise starts here.

Access Rain Bird Learning today.

LEARN MORE



SMARTER. FASTER. HANDIER.

Get the Rain Bird® Resources App for Quick Access to Critical Information.

- The Knowledge You Need in Seconds
- Save and Share Commonly Used Tools
- Free with No Login Required



Saving Water Since 1933



Saving Forests



Saving You Time

Now Featuring:

- **Live Chat:** Message a Rain Bird representative with the click of a button
- **Rewards:** Easy access to your rewards account
- **Tablet Compatibility:** Improved, tablet-friendly design
- **Push Notifications:** Get notified of latest news and promos
- **Quote Tool:** Generate a wishlist and submit to your Rain Bird reseller for a quote



< Scan to download the app today.



Follow Us on Social Media
so you're always up to speed on new product innovations and important updates.



Rain Bird Corporation
6991 E. Southpoint Road
Tucson, AZ 85756
Phone: (520) 741-6100
Fax: (520) 741-6522

Rain Bird Corporation
970 West Sierra Madre Avenue
Azusa, CA 91702
Phone: (626) 812-3400
Fax: (626) 812-3411

Rain Bird International, Inc
1000 West Sierra Madre
Azusa, CA 91702
Phone: (626) 963-9311
Fax: (626) 852-7343

® Registered Trademark of Rain Bird Corporation

© 2026 Rain Bird Corporation

RainBird.com

