



RM-1T One-Button Transmitter (with STX™ Security)

Contents



DESCRIPTION	2
BEFORE REGISTERING THE TRANSMITTER	4
REGISTERING THE TRANSMITTER WITH A RECEIVER ..	5
TESTING THE SYSTEM	7
USING THE TRANSMITTER	8
OPERATING A REMOTE SEQUENCE	9
OPERATING A CONTROLLER PROGRAM	11
INSTALLING ACCESSORIES	12
REPLACING THE BATTERIES	13

© 2000 Rain Bird Sprinkler Mfg. Corp. 3/00

DESCRIPTION

The Rain Bird RM-1T One-Button Transmitter is a battery powered, portable transmitter designed for use with any Rain Bird remote receiver (sold separately). The transmitter sends a radio-frequency (RF) signal to the receiver, which then sends commands to a Rain Bird remote-ready irrigation controller. The transmitter can operate at a range of up to 500 feet (153 m).

“Registering” the Transmitter

Each transmitter is pre-coded at the factory, so no field-coding is necessary. The code is unique, like a fingerprint. To use a transmitter with a receiver, you only need to “register” the transmitter in the receiver’s memory.

The transmitter’s STX™ protocol prevents the transmitter from responding to random RF signals. (For example, the neighbor’s garage door opener will not start a watering cycle.)

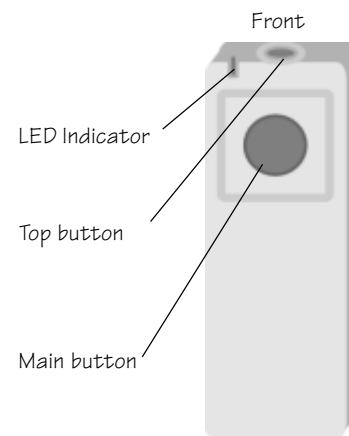

Each transmitter can be registered in multiple receivers, and multiple transmitters can be registered in the same receiver. For example, in this illustration, transmitter ❶ has been registered in receiver A only, while transmitter ❷ has been registered in receivers A, B, and C.

Buttons and Indicators

The top and main buttons perform identical functions. In this manual, “button” refers to either one. The LED indicator lights to show that the button has been pushed and a signal sent to the receiver.

Rear Screws

Screws on the rear of the RM-1T case allow access to the battery compartment and the interior of the transmitter case. You may use a small Phillips head screwdriver to remove these screws.

The RM-1T transmitter can be clipped to a shirt pocket or belt using the removable belt or pocket clip. The case has several screw holes for mounting the belt clip or pocket clip.

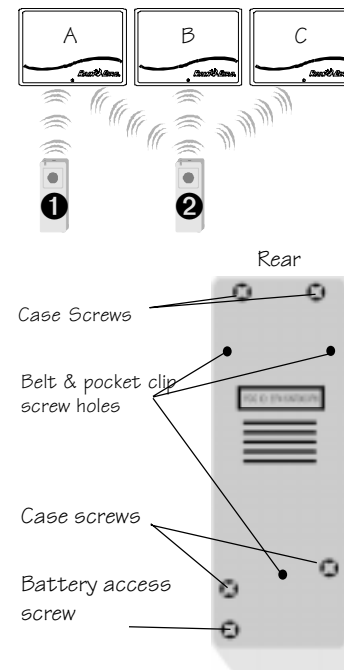

BEFORE REGISTERING THE TRANSMITTER

Memory

There is a limit to the number of transmitters that you can register in a receiver. Before you register a transmitter with your receiver, you may want to determine the number of transmitters already registered.

If necessary, you can erase the receiver's memory and then register new transmitter(s) in the receiver. For instructions, see the manual supplied with your receiver.

Isolation Strip

Your transmitter comes with two type 2032 batteries. Before you register your transmitter, be sure to remove the isolation strip.

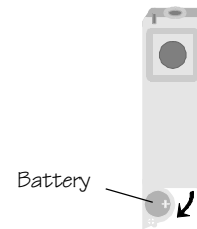

REGISTERING THE TRANSMITTER WITH A RECEIVER

- 1 Remove the cover of the receiver.
Then press and release the Channel 1 button.
- 2 The indicator LED will light for 5 seconds.
- 3 Before the LED goes out, press the transmitter button and hold it down for a count of "2." The transmitter LED will light. Release the button.

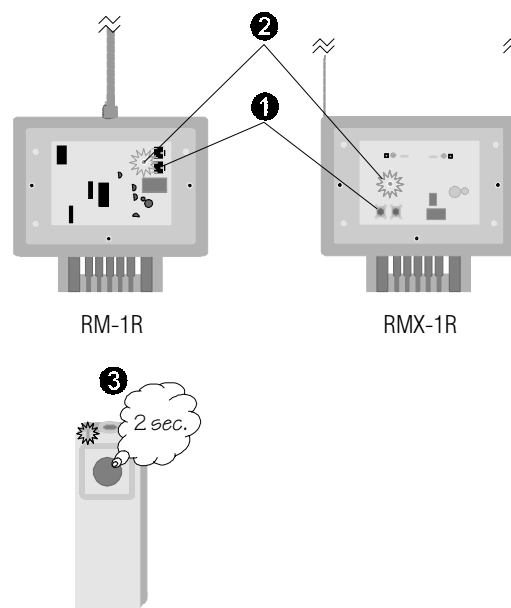

- 4 The receiver LED will flicker and go out, confirming that the signal was received.

If the LED goes out without flickering, repeat steps 1 - 3.

- 5 Hold down the channel 1 button and count the LED blinks on the receiver. The LED will blink once for each transmitter that has been registered with the receiver.
- 6 Repeat steps 1 - 4 for each transmitter you want to register with the receiver.

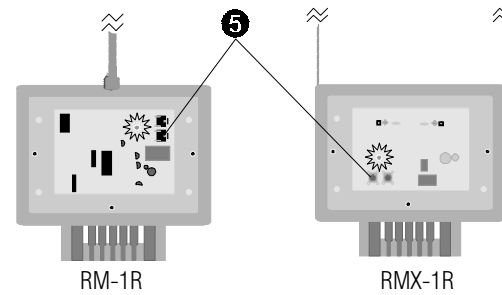
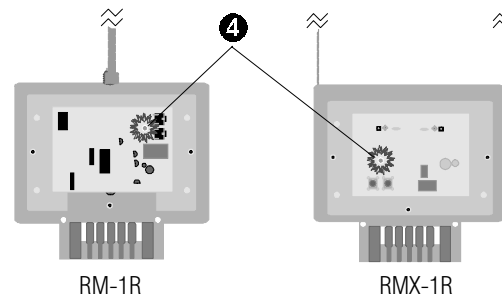

TESTING THE SYSTEM

NOTE: Testing the system begins a watering sequence. Read “Stopping a Remote Sequence” before you test the system.

- 1 Press the button on the transmitter and hold it down for a count of “2.” Release the button.
- 2 The LED on the transmitter will light, indicating the transmitter has sent a signal to the receiver.
- 3 The LED on the receiver will also light, indicating that the signal was received, and a command was sent to the controller. You may also hear a “click,” which is normal.

Complete the system test by using the transmitter to sequence through the stations and stop, as described in “Using the Transmitter.”

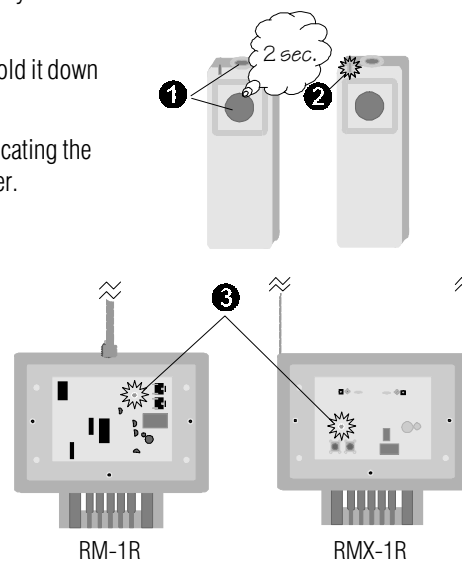

RM-1T One-Button Transmitter

Page 7

USING THE TRANSMITTER

You can use the RM-1T Transmitter to operate all active sprinkler stations in sequence. This is called a "remote sequence." You can also use the transmitter to advance through a controller program that is already running.

Remote Sequence

Running a remote sequence of all sprinkler stations can be useful for:



- Spot watering
- Winterizing
- Conducting a walk-through inspection
- Station testing after maintenance

Controller Program



Advancing or stopping a normal controller program while it is running can be useful if you need to:

- Bypass a station
- Immediately stop all watering

REMOTE SEQUENCE

-  = start remote sequence
-  = advance to next station
-  = stop remote sequence

CONTROLLER PROGRAM

-  = advance to next station
-  = stop controller program

OPERATING A REMOTE SEQUENCE

Starting a Remote Sequence

- 1 Press and hold down the transmitter button for a count of "1." Release the button.

Each station that has a programmed run time (in any program) will operate automatically for a maximum of 10 minutes.

The remote sequence always begins with the first station. The rest of the stations will operate in numerical order, from lowest to highest.

- 2 The station number currently running will appear in the controller's display, along with its remaining run time.

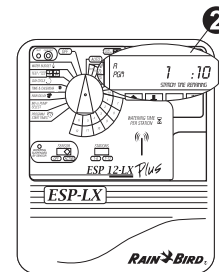
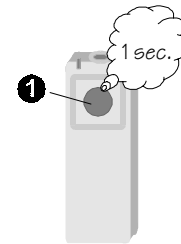

Advancing a Remote Sequence to the Next Station

- 1 Press the transmitter button and hold it down for a count of "1." Then release the button. The next station in sequence will begin operating, and the station previously running will stop.
- 2 The controller will display the station number currently operating, along with its run time.

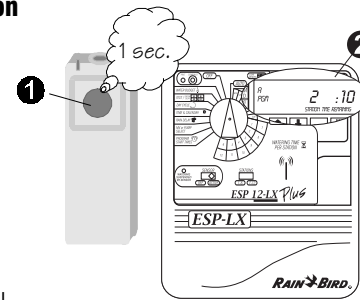

Stopping a Remote Sequence

- 3 Press the transmitter button and hold it down until all watering stops (about 4 seconds). While you are holding the button down, the controller will temporarily advance to the next station. Then the remote sequence will end.
- 4 The controller will return to the state it was in before the remote sequence started.

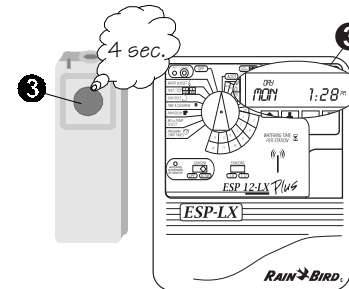

OPERATING A CONTROLLER PROGRAM

Advancing a Controller Program to the Next Station

- 1 To advance through a normal controller program that is already running, press the transmitter button and hold it down for a count of "1." Then release the button. The next station in the program's sequence will begin operating, and the station previously running will stop.
- 2 The controller will display the station number currently operating, along with its run time.

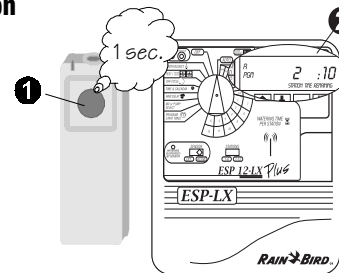

Stopping a Controller Program

- 3 To stop a controller program that is currently running, press and hold the transmitter button until all watering stops (about 4 seconds). While you are holding the button down, the controller will temporarily advance to the next station. Then the program will end.
- 4 The controller will return to the state it was in before the program started.

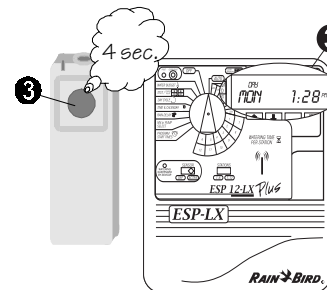

INSTALLING ACCESSORIES

For carrying convenience, you may attach either the pocket clip or the belt clip to the back of the transmitter. Both clips are included with the transmitter.

Attaching the Pocket Clip

- 1 Attach the pocket clip to the back of the transmitter with the two screws provided.

Attaching the Belt Clip

- 2 Attach the belt clip to the back of the transmitter with the three screws provided.

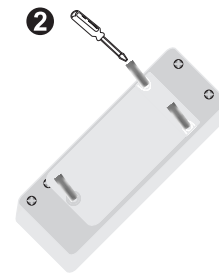
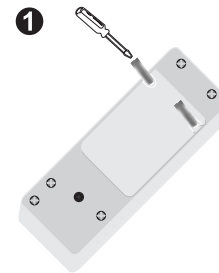

REPLACING THE BATTERIES

- 1 Flip the transmitter over so the back is facing up. Remove the battery access screw from the back of the transmitter.
- 2 Gently pry open the battery compartment with a screwdriver.
- 3 Swing out the battery compartment.
- 4 Remove the old batteries.

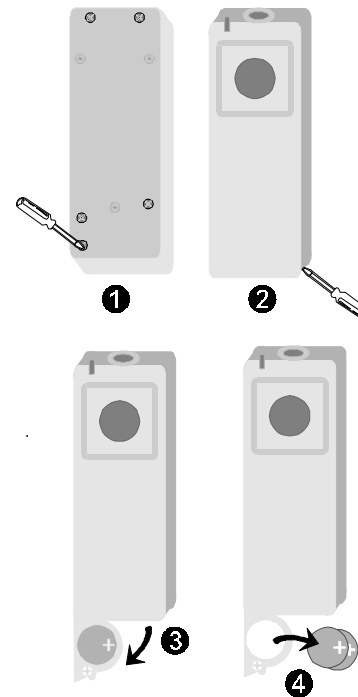

RM-1T One-Button Transmitter

Page 13

- 5 Insert two new 3-volt lithium batteries (type 2032) snugly into the battery compartment. Make sure the + side of each battery faces the front of the transmitter.

NOTE: ALWAYS replace both batteries at the same time. NEVER combine old and new batteries.

- 6 Close the battery compartment.
7 Replace the battery access screw.

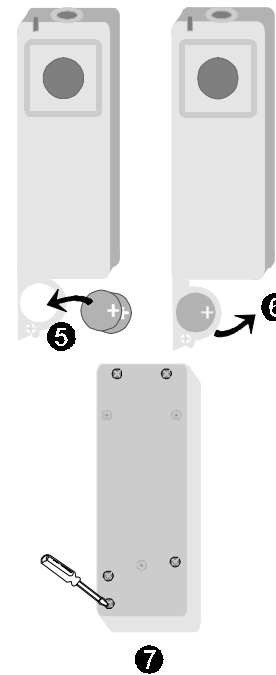

RM-1T One-Button Transmitter

FCC ID: EF4 SNT00376

CANADA, IC: RSS/CNR210 1078 102 1856 5 2

This device complies with FCC Part 15 and IC Rules and Regulations. Operation is subject to the following two conditions: (1) This device may not cause harmful interference, and (2) This device must accept any interference received, including interference that may cause undesired operation.

RM-1T One-Button Transmitter

Page 15



145 North Grand Avenue, Glendora, California 91740, U.S.A. 626-963-9311

© 2000 Rain Bird Sprinkler Mfg. Corp.

® Registered trademark of Rain Bird Sprinkler Mfg. Corp.

Technical Services: 800-247-3782

<http://www.rainbird.com>

P/N 634259A